

Keeler Tavern



Museum
and History Center

152



Annual Report 2016 – 2017

152



*Seated (l to r): Pat Stephens, Hilary Micalizzi, Elise Haas.
Standing (l to r): Phyllis Robertson, Charlie Pankenier, Teri Fischer, Rhonda Hill,
Cheryl Crowl, Karen McChesney, Constance Fenton, Joel Third, Margo McEachern.*

Vision

To be the region's preferred historic site for interpreting three centuries of lived experience and its larger meaning in the history of New England and the nation.

Mission

Keeler Tavern Museum and History Center (KTHC) is dedicated to assisting visitors, students, and scholars in understanding significant lives and events during the site's 300-year history, including their meaning for citizenship and culture, now and in the future. We pursue this mission by preserving and protecting the museum's physical and intellectual assets and sharing them with the widest possible audience, whether on our campus or through programs of outreach.



*Seven former presidents joined to celebrate the Museum's 50th anniversary in 2016
(l to r): Elise Haas, Pat Stephens, Kam Daughters, Clara Horaj, Carol Vazzana,
Cheryl Crowl, Joel Third.*

Board of Directors 2017-2018

Officers

President	Hilary Micalizzi
1st Vice-president	Rhonda Hill
2nd Vice-president	Teri Fischer
Secretary	Sara Champion
Treasurer	Shen-Zhuang Chien

Committee Chairpersons

Community Relations	Barbara Cmiel
Education/Guide Training	Cheryl Crowl
Gardens/Membership	Connie Fenton
Newsletter	Elise Haas
Programs	Patty Linnon
Curator of Exhibits	Karen McChesney
Gift Shop	Margo McEachern
Marketing	Charlie Pankenier
Restoration	Phyllis Robertson
Archives	Pat Stephens
Development	Joel Third
Special Tours/Volunteer Recognition	Maureen Tucker

Staff

Executive Director	Hildegard Grob
Associate Director	Mary Ann Connors
Associate Director	Angela Liptack
Museum Educator	Melissa Houston
Assistant Museum Director	Catherine Prescott
Curator of Collections	Erika Askin
Caretaker	Roger Keller

FROM THE PRESIDENT

People sometimes ask: what was it about Keeler Tavern Museum that drew you in as a volunteer more than 25 years ago?

If memory can be trusted, I was attracted first by its historical importance to the town, and second by the fact that I could be part of a remarkable cultural asset.

Since that time, I have come to learn that it was the foresight and sacrifice of a handful of dedicated founders that brought this Ridgefield gem to life, and that it thrives through the dedication of its volunteer base and the generosity of



its donors. With the benefit of 50 years of strong leadership, this institution has more than fulfilled its mission of preserving and protecting physical and intellectual assets while sharing timeless stories of citizenship and culture across three centuries.

As we begin our next half-century, the purchase of the red brick building at 152 Main Street promises to open an exciting new chapter in our history. This addition to our campus will enhance visitors' experiences with a formal Visitor Center, including more expansive exhibit capacity, and additional (and much-needed) office space for our hard-

pressed staff. It will also provide us with state-of-the-art archival space for our collection of artifacts.

In an era where many museums are contracting, we are growing to meet the expanding needs of our public and student visitors. Thank you all for your support of this wonderful treasure.

Hilary Micalizzi
President, Board of Directors

EXECUTIVE DIRECTOR'S REPORT

At our annual Cannonball Gala, we present the Anna Keeler Award for excellence in teaching history and civics using our site as a living classroom. The award is named for the youngest daughter of innkeepers Timothy and Esther, who defied female stereotypes of her time. As a young woman Anna taught and earned a salary—albeit modest, and a fraction of what male counterparts were paid. Later, she insisted on teaching her Irish immigrant maids how to read and write, perhaps motivated by a civic



duty to help these girls assimilate into a new—and unwelcoming—society.

Our school programs are based on this premise: teaching local history is the best way to understand the meaning of national events. Through the lives of residents such as Anna Keeler, we can follow the thread of civic engagement that has enabled us to keep our republic vibrant for 230 years.

The chart on Page 3 shows the dramatic growth in students we are serving, drawn not only from Ridgefield, but from across Fairfield County. With the integration of 152 Main Street into our campus, we hope to double our student capacity by 2020. Our “faculty” of trained school docents make these

programs possible, volunteering hours of time and untold energies.

Generous donors have supported reduced admission pricing and subsidized busing for hundreds of students from schools in underserved communities, such as Danbury and Bridgeport. Providing this experience to students from diverse backgrounds to help them understand the past as they build their own futures as citizens is very rewarding, and ultimately what KTHC is all about.

Hildegard M. Grob
Executive Director

Whether measured in student days, schools participating, program offerings, or professional regard, education in citizenship and culture continued to develop as a major strategic initiative for KTHC. Our collections provided primary source documents and artifacts as skilled docents led immersive, full-day programs on Colonial life, the Battle of Ridgefield, the Civil War, and Ridgefield's Gilded Age, earning a growing area-wide reputation for educational excellence.

Esther's Kitchen is all about Colonial family life, which includes learning about spices and herbs.



These 5th graders are practicing two lost arts: penmanship, and writing with a quill.



Our collection of Hartmann photographic plates provides today's students with a portrait of lives in turn-of-the-century Ridgefield.

KTHC School Programs by Grade Level

PROGRAM	PRE-K, K	1-3	4	5-6	7-8	9-12
Colonial Times: Esther's Kitchen (Family Life); Timothy's Tavern (Community Life)	X	X	X	X		
Colonial Times Extension Activities: Quill Pen Writing, Embroidery, Dancing, Tavern or Outdoor Games, Ice Harvesting, Farm Tools=STEM (18 th C. & 19 th C. planting cycle and dairy farming), Ledgers=STEM (trade and barter transactions as the economic basis of early village life); Debate to join the Revolution	X	X	X	X		
National Connections: The American Revolution <i>The Battle of Ridgefield</i>				X	X	X
National Connections: The American Civil War <i>Ridgefield during the Civil War</i>				X	X	X
National Connections: The Gilded Age <i>Ridgefield, the Gilberts, and the Gilded Age</i>					X	X
Classroom Outreach: Colonial Keeler Tavern	X	X	X	X		
Classroom Outreach: The American Revolution and Ridgefield				X	X	X
Classroom Outreach: The Civil War and Ridgefield				X	X	X
Classroom Outreach: The Gilded Age and Ridgefield					X	X
#HandsonHistory: A rotating, interactive exhibition of Museum artifacts during the month of October	X	X	X	X	X	X



Ending a day-long immersion in the Gilded Age, 8th graders re-enacted Julia Gilbert's Garden House receptions for departing doughboys.

EDUCATION NEXT

In the years ahead, the availability of our new Visitor Center will address one major challenge: sufficient classroom space, permitting us to accommodate more students from across the region, especially those from underserved Title I schools. And, we intend to expand the range of our offerings, including outreach programs in which we bring the Museum to the classroom, either as preparation for a visit, or as a stand alone learning experience. On campus or away, we will depend on committed and prepared individuals to join our “faculty,” where they will find a demanding but rewarding opportunity.



Moderated by Patriot Timothy Keefer, students debate whether or not to join the Revolution in the very same Assembly Room where the citizens of Ridgefield would have discussed this issue.

“This place is a treasure!”

– Ridgefield middle school teacher

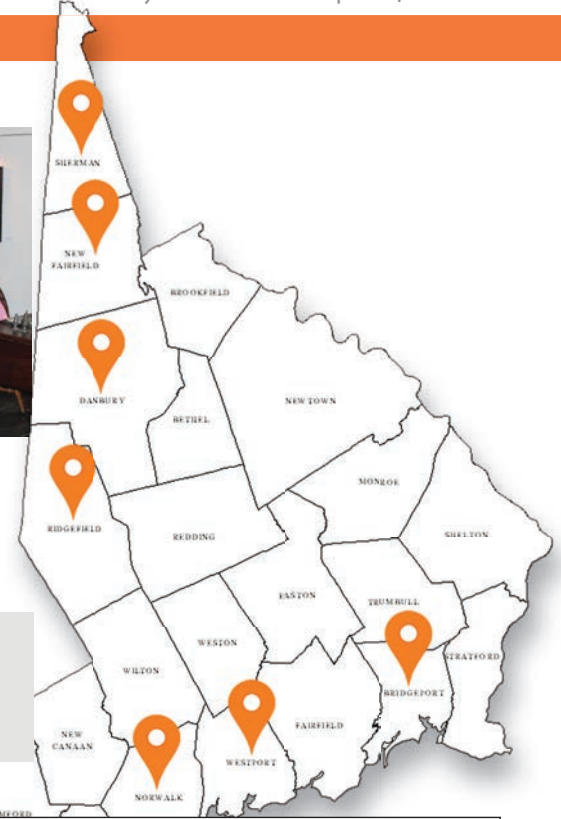

“Thumbs up for history!” Generous donors have supported reduced admission pricing and subsidized busing for hundreds of students from schools in underserved communities.

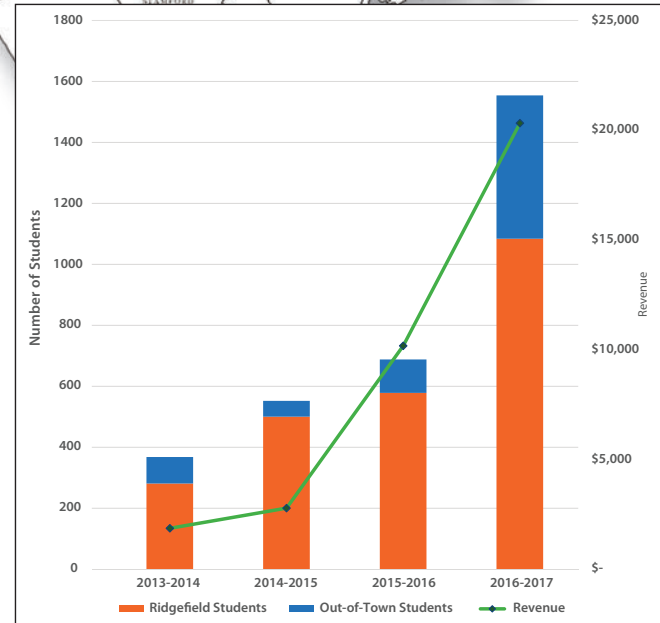

KTHC school programs have tripled over the past three years.

The thousands of visitors to our campus each year come for a variety of reasons, drawn by the diversity and quality of our programs. Most have history at their core, although it may come wrapped in what can be described as diversion, or even entertainment that appeals to youngsters, families, and those old enough to have witnessed their share of history in person. What do we expect that they will take away? New insights into the meaning of citizenship in our American experience. In the words of noted author David McCullough: "History is who we are and why we are the way we are."



The Holiday Art Show in the Carriage Barn featuring local artists has become a favorite with the public.



The Phillip Burr Bradleys defended their History Trivia championship, capturing a second Fountain Trophy at our annual contest.



Visitors to popular Lantern Light tours found our campus alive with characters from across three centuries, including a Halloween-themed party.



At #HandsOnHistory, visitors could experience tools and techniques that years ago gave "farm-to-table" a very different meaning





“Wonderful historical experience...and knowledgeable guides with great stories to tell.”

– Visitor Review



Programs and events at KTHC throughout the year for all ages range from the town-wide reenactment of *The Battle of Ridgefield*, to the *Reading of the Declaration of Independence on July 4th*, *Keeler Kids summer camp*, the *Barn Tag Sale*, *Scarecrow contest*, and *’Twas the Night Before Christmas* for families with young children, to name just a few.



In FY 2016-17, KTHC's income was stable, consistent with trends in recent years, and in contrast to many of our U.S. colleagues.

This is, in part, something of an irony: because we have historically received less than one percent of our operating funds from local, state, or federal sources (compared with the museum average of 24 percent), we are relatively unaffected by continuing significant reductions in government outlays for cultural institutions.

SOURCES OF FUNDS

(net of expenses)

Donations	\$ 112,782
Education	\$ 15,671
Fundraising	\$ 70,464
Garden House	
Rental Income	\$ 114,545
Grants	\$ 11,503
Membership	\$ 21,391
Other Programs	
and Events	\$ 15,513
Reserve Withdrawal	\$ 111,655
	<hr/>
	\$ 473,523

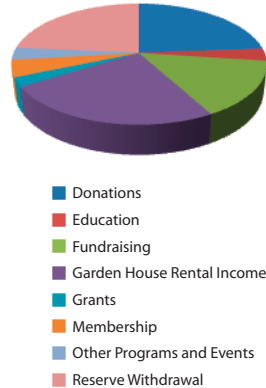

Our current financial situation requires well-above-average museum income earned from operations, which increased more than 15 percent from the prior year. Much of the growth is attributable to rentals of the Garden House, a sought-after venue for weddings and other celebrations. And we continue to rely on substantial income generated by our reserve to support our operations.

WHY A RESERVE MATTERS

Of the estimated 15,000 museums across the country—more than the number of McDonald's—the vast majority operate at a deficit. So do we. That is one reason why professional groups advise non-profits to maintain a reserve that can support between 25 and 100 percent of annual operating expenses. We manage our own reserve so that it can reliably produce at least that minimum figure, year after year.

Moreover, while an art museum's capital investments—acquiring a painting, or opening a new gallery—can be discretionary, a 300-year-old property's failing roof or collapsing chimney are anything but. So, we perform a constant balancing act: sustaining reserve levels sufficient to generate essential operating income, drawing on principal as required to preserve a landmark, and pursuing once-in-a-generation opportunities.

"...can't wait to tell everyone about a wedding day gem!" —A recent bridal couple

USES OF FUNDS

Expenses declined slightly in the fiscal year, even as the organization expanded education programming and staffing, maintained an active program calendar, and absorbed 12 months of carrying costs for the 152 Main Street building.

In part, this reflected a considerable reduction in Restoration expense, as we benefited from major capital investments in

prior years, as well as a 28 percent decline in Administrative costs.

We will continue to treat 152 Main Street as a separate entity for accounting purposes, until such time as it has been fully integrated into our day-to-day operations.

USES OF FUNDS

Collections	\$ 3,931
Marketing	\$ 38,044
Museum Restoration	\$ 30,087
Operations	\$ 356,784
General Administration:	\$ 41,701
Insurance:	\$ 28,212
Personnel:	\$217,141
Repair & Maintenance:	\$ 44,630
Utilities:	\$ 25,100
152 Main Street Expenses	\$ 44,677
	\$ 473,523



During Fairfield County Gives in March, generous donors contributed enough in 24 hours to conserve these 19th century children's party outfits.

152 MAIN STREET PROPERTY

SOURCES OF FUNDS

Funding from KTM	\$ 44,677
Rental Income	\$ 19,225
Reserve Withdraw	\$ 26,428
	\$ 90,330

USES OF FUNDS

FCB Loan Interest	\$ 40,483
Ground Maintenance	\$ 2,747
Property Tax	\$ 17,605
Repair & Maintenance	\$ 3,350
Site Development	\$ 19,411
Utilities	\$ 6,735
	\$ 90,330

More than just an historic landmark, Keeler Tavern Museum and History Center is a lively showcase, telling a sweeping, 300-year story... a window onto the American experience. Our plans for 152 Main Street will transform how we tell that story:

A New Visitor Center will also be dedicated to museum exhibition and classroom space as well as administrative offices.

On-Demand Classroom Space: Our strategic plan has education as its cornerstone, with one-of-a-kind learning experiences. Programs serving 80-90 pupils per day require multiple child-friendly spaces for rotating successive groups through learning stations.

Ready Access to Documents and Artifacts: The Visitor Center's renovated basement level will provide a climate-controlled, secure and readily-accessible storage and work area for our archives and selected artifacts.

Secure Exhibition Space: With a well-designed, space-efficient exhibition area, we can expect visitors to return for multiple new experiences—an expansion of public service that is vital both to our mission and our financial sustainability.

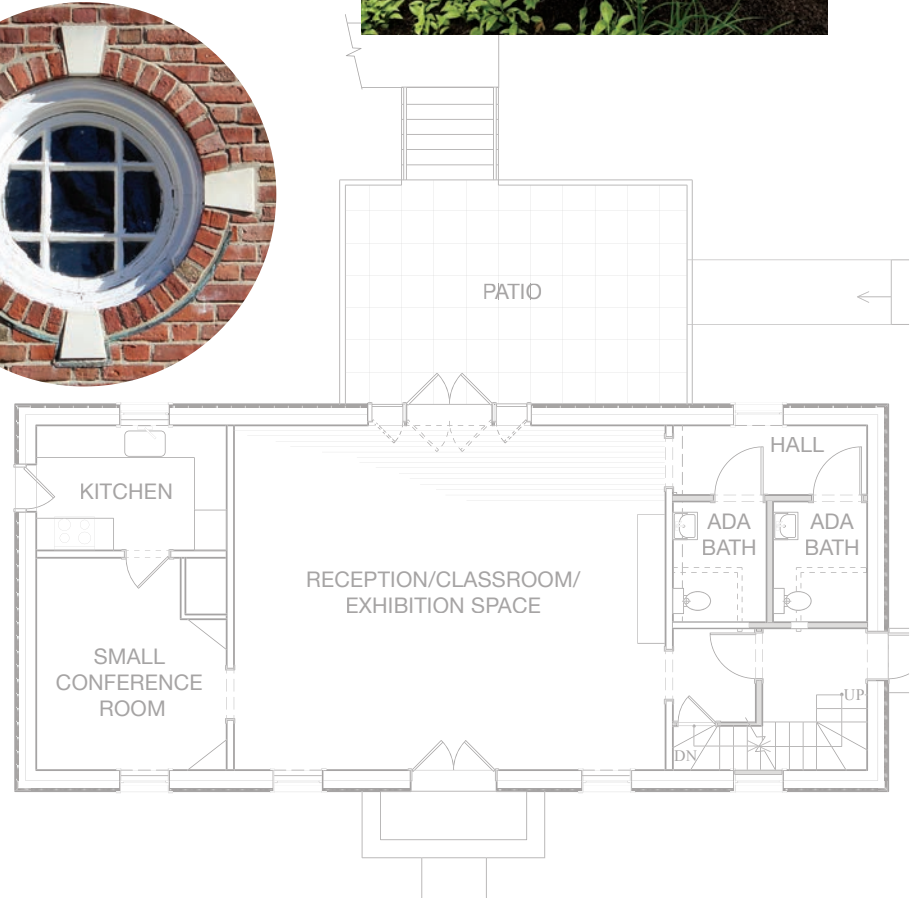

DONORS, MEMBERS AND VOLUNTEERS

\$10,000 and Over

Ms. Joan Payden ✨

\$5,000 to \$9,999

Olga B. Cohen Estate
Fairfield County Bank Corporation

\$1,000 to \$4,999

Ms. Elizabeth Beresford ✨
 Mr. and Mrs. Mark Blandford ♥
 BMW of Ridgefield/Mr. and Mrs. Edmund McGill ♥
 Ms. Paula Curry and Mr. Robert Bojanek ★ ♥
 Connecticut Humanities
 Ms. Jeanne M. Cook ✨ ♥
 Mr. and Mrs. Robert Ellis ★
 Mr. and Mrs. John Fenton ★ ♥
 Mr. and Mrs. Robert Galvin ★
 GCInfotech
 Goldstone Family Foundation ✨
 Mr. and Mrs. Reinhold Grob ★ ♥
 Mr. and Mrs. Douglas D. Haynes ★
 Harvey Hubbell Foundation
 IBM International Foundation/
 Matching Grants
 IBM Corporation/Community Grants
 Kane Funeral Home
 Mr. Fred E. Keeler III ✨
 Wadsworth Russell Lewis Fund
 Lodewick Foundation
 M & T Bank Foundation
 Ms. Miriam Martinez
 and Mr. Roger Restaino ★ ♥
 Ms. Margo McEachern ✨ ★ ♥
 Mr. and Mrs. Frank Micalizzi ★ ♥
 Mr. and Mrs. Charles Pankenier ★ ♥
 Mr. and Mrs. David Partridge
 Society of the Cincinnati in the State of CT
 Mr. and Mrs. Chris Spahn
 Strategic Funding Source, Inc.
 Mr. Joel Third ✨ ♥
 Sarah Tod Fund
 Mr. and Mrs. Richard Vazzana ✨ ♥

This list recognizes the many people whose contributions are the heartbeat of KTHC, and which might take the form of finances, in-kind donations, volunteer energy—or all three. Capital contributions will be acknowledged separately in the near future.

\$500 to \$999

Mrs. Catherine Baker ✨ ♥
 Ms. Beverly Barnard
 Mrs. Beth Becker ★
 Ms. Georgia Carrington ★ ♥
 Colonial Cleaners
 Mr. and Mrs. John Connors ★ ♥
 Mr. and Mrs. Christopher Crowl ✨ ♥
 Mr. and Mrs. Donald Daughters ✨ ♥
 Ms. Mary Jessie Des Closets ✨
 Mr. and Mrs. Gary DiElsi ★
 Diversified Brokerage, Ltd.
 Mr. and Mrs. Nick Donofrio ★ ♥
 Mr. and Mrs. Kevin Fischer ★ ♥
 GE Foundation
 Ms. Rhonda Hill ★ ♥
 Mr. and Mrs. Thomas Johnstone ★
 Mr. and Mrs. Frank Kromer ★ ♥
 Mr. and Mrs. James Liptack ★ ♥
 Mr. and Mrs. Vincent Maneri ★ ♥
 Mrs. Karen McChesney ★ ♥
 Montanari Fuel Service, Inc.
 Mr. and Mrs. Dan O'Brien ★
 Ridgefield Overhead Doors ★
 Reynolds and Rowella
 Ridgefield Woman's Club
 Mr. and Mrs. John Robertson ✨ ♥
 Mr. Albert L. Ryff ★
 Ms. Suzanne Scoville and
 Mr. David Sederholt ★ ♥
 Mr. and Mrs. Norman Seifer ★ ♥
 Mr. and Mrs. Walter Slavin ★ ♥
 Mr. and Mrs. Jay Steele ★ ♥
 Trillium Architects, LLC
 Union Savings Bank
 Mr. Stephen Reynolds and Dr. Susan Wolf ★

Mr. and Mrs. Bill Wyman ★
 Mr. and Mrs. Gregory Zaic ★ ♥

\$100 to \$499

Mrs. Kay Ables ★ ♥
 Dr. and Mrs. Randall Baldwin ★
 Mr. and Mrs. Christopher Bennett ★
 Mr. and Mrs. Robertson Bennett ★ ♥
 Mr. and Mrs. Aldo Biagiotti ★
 Mr. and Mrs. Fabio Biagiotti ★
 Mr. John Blood ★
 Mr. and Mrs. John Boehle ★ ♥
 Mr. and Mrs. Jean Paul Boillot ★
 Mr. and Mrs. Jeffrey Boris ♥
 Ms. Pearl Broms
 Mr. and Mrs. Max Caldwell ★
 Mr. and Mrs. Robert Camera ★
 Caraluzzi's Markets Fund
 Ms. Mary Lou Chaffee ★
 Ms. Sara S. Champion ★ ♥
 Mr. and Mrs. Chris Christiansen ★
 Mr. and Mrs. Warren Clark ★
 Mr. Joseph Cleary ★
 Mr. and Mrs. Ted Cleveland ★ ♥
 Mr. and Mrs. Doug Clewell ★ ♥
 Mr. and Mrs. Stephen Cluney
 Mr. and Mrs. Richard Cohen
 Mr. and Mrs. James Coleman ★
 Mr. and Mrs. Gary Condon ★
 Mr. and Mrs. Doug Coombs ★
 Mr. John Cornelius ★
 Ms. Linda Costa ★
 Crehan & Crehan, Attorneys at Law ★
 Mr. and Mrs. Doug Cushnie
 Mr. and Mrs. Luke Daigle ★
 Mr. and Mrs. Murray Darvick ★ ♥

continued

★ Current Member ♥ Volunteer ✨ Life Member

\$100 to \$499, continued

Mrs. Richard Dempsey ★ ♥
 Mr. and Mrs. William Diamond
 Mrs. Sandra Dickinson ♥
 Mr. Michael Donofrio
 Mr. and Mrs. Jeff D'Onofrio
 Dr. and Mrs. John Donovan ★ ♥
 Dometown Ridgefield, Inc.
 Mr. and Mrs. Joseph Egan ★ ♥
 Mr. Ralph Ellis ★
 Ms. Inga Engstrom ★
 Ms. Susan Enis ★ ♥
 Mr. and Mrs. Ted Ericson ★
 Mr. and Mrs. Fred Ernst ★
 Dr. and Mrs. John Fisher ★
 Mr. Ken Fitch
 Ms. Jo Frame ★ ♥
 Mr. and Mrs. Eric Freidenrich ★
 Mr. and Mrs. Tom Fry ★ ♥
 Ms. Julie Gallagher ★ ♥
 Dr. and Mrs. Nelson A. Gelfman ★
 Mr. and Mrs. Randall Glendinning
 Mr. and Mrs. Brendan Gunderson
 Mr. and Mrs. George Hancock ♥
 Mr. and Mrs. Jeffrey Hansen ★ ♥
 Mr. and Mrs. Steve Hartman ★
 Mr. and Mrs. Patrick Hoban ★
 Mr. and Mrs. Rob Jasminski ★
 Mr. and Mrs. Michael Jaykus ★ ♥
 Mr. and Mrs. Bob Jones ★
 Ms. Mary Kaletta ★ ♥
 Dr. and Mrs. Robert W. Keeler ★
 Mr. and Mrs. Sidney Kelley, Jr. ★
 Ms. Danielle Greenberg
 and Mr. Victor Klebanoff ★
 Mr. and Mrs. Tom Kozlark ★ ♥
 Mr. and Mrs. Joseph Kreitz
 Mr. and Mrs. Jeffrey Krulwich ★
 Mr. and Mrs. Robert Leavitt
 Mr. and Mrs. Kurt Liddi ★ ♥
 Mrs. Joyce Ligi ★
 Ms. Patricia Linnon ★ ♥
 Look LLC - Woolworth ★ ♥
 Mr. and Mrs. Jeffrey Lundberg ★
 Mr. and Mrs. Gene Lutz ★ ♥

Mr. and Mrs. Bruce Maguire
 Mr. and Mrs. Lawrence Mango
 Ms. Sue Manning ★
 Ms. Laurie Mariani ★
 Mr. William F. Mayr ★ ♥
 McMaster Family Foundation/Dr.
 and Mrs. Lee McMaster ♥
 Mr. and Mrs. Paul McNamara ★
 Mr. and Mrs. Douglas Millan Jr.
 Mr. and Mrs. Greg Moreau ★
 Mr. and Mrs. Robert Morris
 Mr. and Mrs. Ron Mosiello ★ ♥
 Mr. and Mrs. Michael Mueller ♥
 Mr. and Mrs. Joseph Mulvaney ★
 Ms. Christina Nolan
 Mr. and Mrs. John D. Noonan ★ ♥
 Mr. and Mrs. Gerald O'Hara
 Mr. Sean O'Kane
 Mr. and Mrs. George Orlan
 Mr. and Mrs. Ronald Paltauf
 Mr. and Mrs. Bart Pattie ★
 Mr. and Mrs. Nicholas Perna ★
 Mr. Edwin Phelps, Jr.
 Ms. Christina Phillips ♥
 Mr. and Mrs. John Pinchbeck ★ ♥
 Mr. and Mrs. Joseph Pontelandolfo ★
 Mr. Charles Prescott
 and Ms. Shen-Zhuang Chien ♥
 Mr. and Mrs. Thomas Pritchard ★ ♥
 Mr. and Mrs. James Prusko
 Mr. John Queirolo
 Mr. and Mrs. Charles Reardon ★
 Mr. and Mrs. Michael Rettger
 Ms. Kathy Richards
 Ridgefield Independent Film Festival
 Ridgefield Chapter, National Charity
 League ♥
 Mr. and Mrs. Jim Rouse ★
 Ms. Mary Ruggiero ♥
 Ryer Charitable Trust
 Mr. and Mrs. Jack Sanders ★
 Mr. and Mrs. Sam Scatterday ★ ♥
 Mr. and Mrs. Richard Schumann ★
 Mr. and Mrs. Joel Simon ★
 Mr. and Mrs. Philip Sine
 Mr. and Mrs. Gary Singer ★ ♥

Mr. and Mrs. David Smith ★
 Mr. and Mrs. John Somma ★ ♥
 Spring Lake Garden Design, Inc.
 Mr. James R. Steiger ★
 Mr. and Mrs. George Stueck ★
 Sunburst Plumbing & Heating
 Mr. and Mrs. Angelo Tartaro ★ ♥
 Ms. Margaret Prescott Thomas ★
 Mr. and Mrs. Joseph Trench ★ ♥
 Mr. and Mrs. Mark Trench ♥
 Mr. and Mrs. Michael Troy ★
 Ms. Maureen Tucker ★ ♥
 Mr. and Mrs. Howard Tuthill ★
 The UPS Store
 Ms. Kim Welton ★
 Ms. Angelyn Williams
 Ms. Jo Ann Williams ★
 Mr. and Mrs. Alan Winsor ★
 Mr. and Mrs. Tom Wolf ♥
 Mr. and Mrs. D. Stephen Wooters ♥
 Mrs. Beth Yanity ★
 Mr. and Mrs. David Yolen ♥
 Mr. and Mrs. Darwin Yoran ★
 Mr. and Mrs. John Zidik ★

Up to \$100

Mr. and Mrs. Ralph Ablon ☆
 Ms. Lois H. Adamsen ★ ♥
 Mrs. Raelene Ali ★
 Ms. Arlan Anderson
 Mr. and Mrs. Michael Anderson
 Ms. Sue Bankes ★ ♥
 Ms. Julia Post Bastedo ☆
 Mr. and Mrs. Vernon Beck
 Ms. Ellen Becker ★
 Mr. and Mrs. Randy Black ☆
 Mr. and Mrs. Brian Bligh ★
 Ms. Carol Anne Bootle ★
 Mr. and Mrs. Donald Bostwick ★ ♥
 Mr. Thomas Broderick ★
 Mr. and Mrs. Jeff Burns
 Dr. Barbara Christen ★
 Mr. Donald Ciota ★
 Ms. Barbara Cmiel ★ ♥

Ms. Anne Cook ★♥
 Ms. Torrey M. Cooke ★
 Ms. Lisa Cooper
 Mr. and Mrs. John Couri ☼
 Mr. and Mrs. Richard Crai ★
 Mr. and Mrs. Charlie Creamer ★
 Mr. and Mrs. Mark Cupkovic ★
 Mrs. Louise Dages ★
 Mr. and Mrs. Jan Desiato ♥
 Ms. Sheila Dick ★♥
 Mr. Gavin Donnelly
 Mr. and Mrs. Jon Elkow
 Ms. Elizabeth W. Esser ★
 Mrs. Jocelyn Fainer
 Ms. Leticia Fantauzzi ★
 Mr. and Mrs. John P. Ferguson
 Ms. Dorothy D. Fielder ★
 Mr. and Mrs. Barry Fisher ★
 Mr. and Mrs. Ira Joe Fisher ♥
 Mr. and Mrs. John Fitzgerald ☼
 Ms. Liz Fleurette
 Mr. and Mrs. Robert Frank
 Mr. Jules G. Franko ★
 Dr. and Mrs. Daniel French ☼
 Mr. and Mrs. James Gareau ★
 Ms. Kate Gluckin ★
 Mrs. Evelyn Godbout
 Mr. David Grant
 Mrs. Carol A. Grasso ★
 Mr. John Grissmer ☼
 Ms. Abby M. Gross
 Mr. and Mrs. Jay Haas ☼♥
 Mrs. A. W. Hall, Jr. ☼
 Rev. Charles Hambrick-Stowe
 Mr. and Mrs. Chuck Hancock ★♥
 Ms. Lizzy Hanson
 Mr. and Mrs. Stephen Harrington ★
 Ms. Kathleen Hartford ★
 Ms. Karen Hausmann ★♥
 Ms. Marion Roper Hiller ★
 Ms. Ruth Holtzthum
 Ms. Joanne Hudson ★
 Ms. Betty Huizinga ★♥
 Ms. Janet Jacobs
 Mr. and Mrs. David Janasek ★
 Ms. Katherine Ann Johnson ★

Mr. and Mrs. Robert Jones ★
 Mr. and Mrs. Richard Kasuli ☼
 Mr. Raymond E. Keefe ★
 Mr. and Mrs. Ronald Keeler
 Mr. Robert Keeler ★
 Mr. Richard Keeler
 Ms. Ann Kopp ★
 Mrs. Bessie Krysiwich ★♥
 Mr. and Mrs. John Kwasnik ★♥
 Ms. Susan Kweskin ★
 Mr. and Mrs. John Lee
 Ms. Christine Lippincott
 Mr. John Longden ☼
 Mr. and Mrs. Bill Lutzius ★♥
 Mr. and Mrs. Richard Mahland ♥
 Mr. and Mrs. Guido A. Maiolo
 Ms. Maria Maley ★♥
 Mr. and Mrs. Tom Maloney ★♥
 Ms. Helen Mannis and Mr. Fritz Mundorff
 Mr. and Mrs. Edward J. McGarvey ★
 Ms. Susan McGourthy ★♥
 Mrs. Robert Mead
 Mr. John F. Metzger ★
 Ms. Carolyn W. Meyers ★
 Ms. Nancy K. Miller ★
 Ms. Pam Miller ♥
 Mr. and Mrs. Robert Moriarty
 Mrs. Mary Morrisroe ★♥
 Ms. Lynn Mullen ★♥
 Phil O'Brien Painting
 Mr. and Mrs. William Osgood ★
 Ms. Liz Otto ★
 Mr. and Mrs. Ed Pearson
 Ms. Catherine Prescott ♥
 Mr. and Mrs. Robert Quasha ★
 Ms. Margie Reynolds ★
 Ridgefield Chamber of Commerce
 Ms. Mary Rindfleisch
 and Mr. Joseph Keneally
 Ms. Carol Roach Murray ★
 Mr. and Mrs. Paul Roche ★
 Ms. Theresa M. Roese ★♥
 Mr. and Mrs. David Saily ★♥
 Ms. Ingeborg Sands ♥
 Ms. Rita Schaffer ★
 Ms. Lenore Schneider ★♥

Mr. and Mrs. Scott Schneider ☼
 Ms. Ellen Scott ★
 Mr. and Mrs. Paul Siegel ★♥
 Ms. Joann L. Spence ★♥
 Dr. and Mrs. Alvin Spindler ★♥
 Mr. Dave Stambone ★
 Ms. Pat Stephens ☼♥
 Ms. Margaret Stern ☼
 Ms. Helen Stevens ★
 Ms. Carol Stoddard ☼
 Mr. and Mrs. Charles Stover ★
 Mr. and Mrs. Joseph Strilowich ♥
 Mr. and Mrs. Donald Sturges ★♥
 Mrs. Sylvia Sturges ★♥
 Mr. and Mrs. Tom Sturm
 Ms. Marisa Tatiwong ★
 Ms. Margaret Thompson ★
 Mr. Julius Tulipani ★
 Mr. and Mrs. Ed Van Den Ameele ★♥
 Ms. Jennifer Wallace ★♥
 Mr. and Mrs. Kenneth Webb
 Ms. Edna Weber ★♥
 Mr. and Mrs. David L. Whitehead ★
 Ms. Emaline Wittman ☼
 Ms. Dorothy Wright ★



Volunteers

Mrs. Laura Agisim
Mr. and Mrs. Michael Asselta
Ms. Carol Baird
Mr. Bob Baker
Ms. Diane Baker
Mr. and Mrs. Andy Bodner
Ms. Anne-Marie Boehme
Mr. and Mrs. David Campbell
Ms. Barbara Carvalho
Ms. Sandra Corday
Ms. Joann Deblasis
Mr. Christopher DiElsi
Ms. Laura Eisenberg
Ms. Beverly Faulds
Ms. Dawn Fawcett
Ms. Laura Forsberg
Ms. Susan Fortunato
Mr. Alex Gabriele
Ms. Barbara Gotch
Ms. Shari Graves
Mrs. Sandra A. Grebinar
Mr. and Mrs. Albert Guido
Ms. Palma Harman
Mr. Keith Harriton
Ms. Fran Head
Dr. and Mrs. Cliff Heidinger
Mr. and Mrs. Corey Herrman
Mr. Benjamin Hume
Ms. Susan Husband
Mr. and Mrs. James Keidel
Ms. Louise Klump
Ms. Nancy Lee Laidlaw
Mr. and Mrs. Kevin Lally
Ms. Barbara Lawrence
Mr. and Mrs. Carl Lecher
Ms. Laura Leonard
Mr. and Mrs. Tom Loporati
Mr. and Mrs. David Liederbach
Ms. Dale Ligi
Mrs. Catherine G. Lipper
Ms. Catherine McHone



Ms. Joan McKenzie
Ms. Bonnie Leavy-Mello
Mr. Justin Mitchell
Ms. Luba Molnar
Nutmeg Chapter, National
Charity League
Mr. Odonoo Oyunbazar
Ms. Ellen Pannish
Ms. Amanda Piazza
Mr. and Mrs. Chris Piazza
Ms. Danielle Piazza
Ms. Lauren Piazza
Ms. Mary Pierandri
Ms. Marybeth Prunty
Ms. Lorna Redup
Mr. and Mrs. Thomas Riedy
Mr. and Mrs. Scott Sanderude
Mr. and Mrs. Steven Scammon
Ms. Alison Sedney
Ms. Naomi Shapiro
Ms. Sarah Slavin
Ms. Marcia Sloat
Ms. Cynthia Veilleux

In-Kind Donors

Abbey Tent & Party Rental
All Seasons Party & Tent Rentals
Books on the Common
Bernard's and
Sarah Bouissou Catering
Ms. Michelle Burke
Carriage House Events
and Catering
Ciao! Catering and Events
Ms. Barbara Cmiel
Colonial Cleaners
Mrs. Jeanne Cook
Mr. and Mrs. John Couri
Mr. and Mrs. Christopher Crowl
Davis Tree & Logging
Deborah Ann's Sweet Shop
Ms. Sheila Dick
Diversified Brokerage
Durants Party Rentals
Mr. and Mrs. Ira Joe Fisher
Founders Hall Quilting Group

Mr. and Mrs. Robert Galvin
Greenlight Limo Service
Mr. Richard Jabara
Mr. Roger Keller
Ms. Cheryn Kwasnik
Mrs. Dan O'Brien
Deborah O'Brien Photography
OHDesign3
Ms. Tina Phillips
The Ridgefield Frame Shop
The Ridgefield Press
Rodier Flowers
Ms. Suzanne Scoville
Mr. and Mrs. Walter Slavin
Sean O'Kane AIA Architect, PC
Ms. Helen Stevens
Strategic Funding Source
Sturges Brothers, Inc.
Tina Cobelle-Sturges
Town Vibe/
Ridgefield Magazine
Mrs. Janine Trench
WSHU Radio



Information through June 30, 2017. If your employer matched your donation, and/or you paid for membership, your name appears in the category that captures the combined total. We apologize for omissions or errors. Please direct corrections to the Museum office.

YOUR GIFT CAN MAKE HISTORY!

What Your Gift Can Do

Contributions from our friends and supporters are critical, because we receive no federal, state, or local government support for operations, and rely on donations and fundraising for nearly 40 percent of our operating budget. Here is how your gift can make a difference:

\$5,000 A portion of our Education Director's salary

\$2,500 Restoration of two 18th-century double-hung windows on the Tavern building

\$1,000 Restoration of 76 square feet of historic brick walkway

\$23 A day's electricity

\$50 50 spring flower bulbs

\$82 A week's water service

\$120 A re-enactor's corset

\$350 Bus for 60 Bridgeport 7th graders to attend a Battle of Ridgefield program

\$500 Two family workshops for #HandsOnHistory, our month-long look at Ridgefield's village life

\$825 Daily expense to keep the Museum open

Please Act Now!

- Complete the enclosed remittance form and mail it to us
- OR
- Go to our secure donation page
www.keelertavernmuseum.org/join&support

Does our past have a future?

It will, if you join others in remembering KTHC in your estate planning. Your legacy gift means that new generations will benefit from a one-of-a-kind window on three centuries of our citizenship and culture and their lasting relevance. Contact our Executive Director Hildi Grob (203-438-5485 or hgrob@keelertavernmuseum.org) to discuss how your bequest can help make history.

Back cover: A drone's eye view of the more expansive KTHC campus.



Keeler Tavern  Museum
and History Center

132 Main Street | Ridgefield, CT 06877 | info@keelertavernmuseum.org | 203.438.5485

